

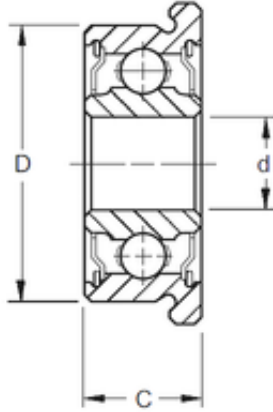

BEARINGS PRODUCTION WHOLESALE CO., LTD

3 mm x 10 mm x 4 mm ZEN SF623-2RS deep groove ball bearings



Bearing No. SF623-2RS

Size	3x10x4 mm
Bore Diameter	3 mm
Outer Diameter	10 mm
Width	4 mm
d	3 mm
D	10 mm
B	4 mm
C	4 mm
Basic dynamic load rating (C)	0,631 kN
Basic static load rating (C0)	0,219 kN

SF623-2RS Bearing 2D drawings and 3D CAD models